

**Fenelon Gold**  
**3D view**  
Looking Northeast  
November 05, 2018

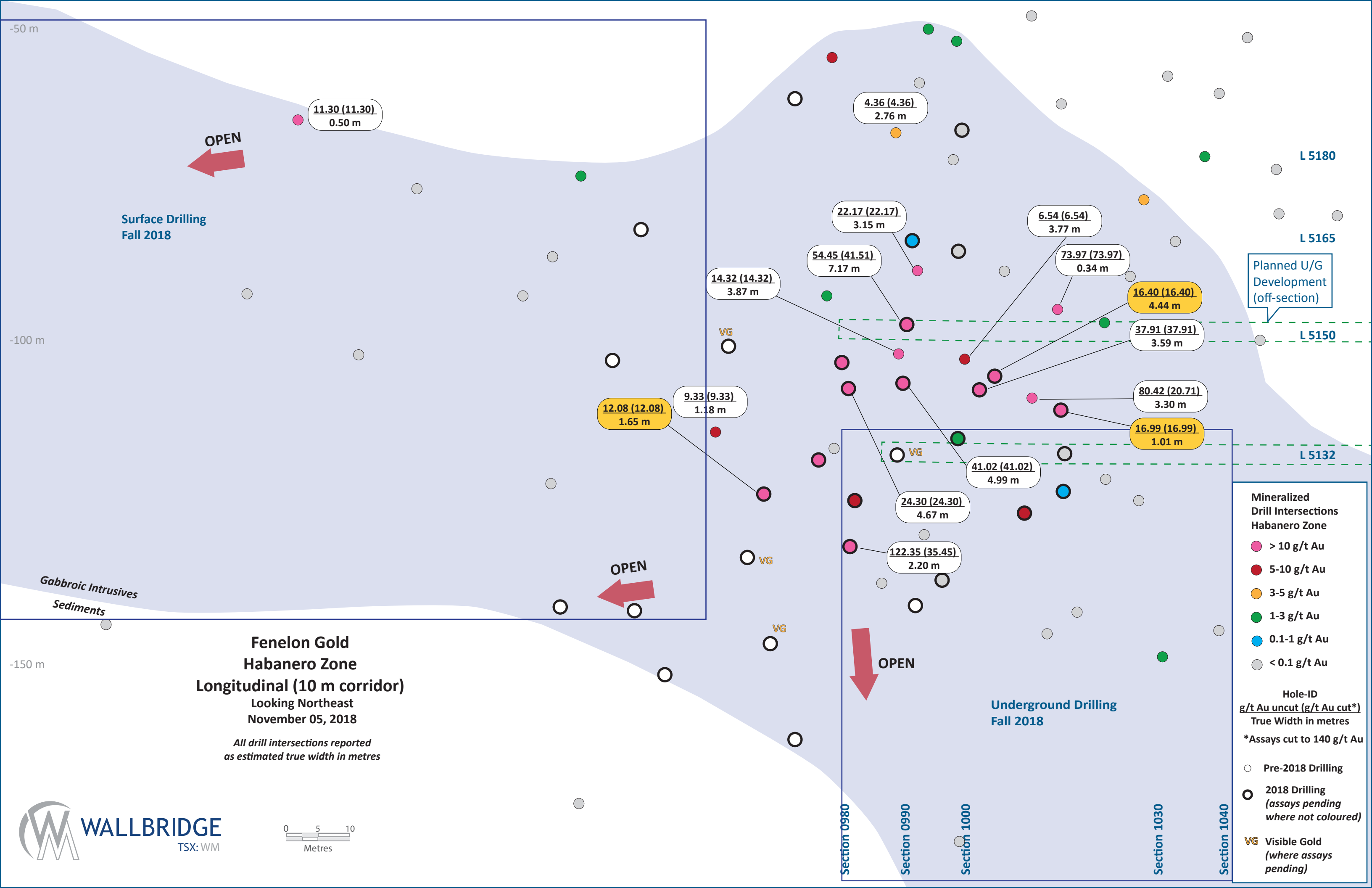

11.30 (11.30)  
0.50 m

4.36 (4.36)  
2.76 m

22.17 (22.17)  
3.15 m

6.54 (6.54)  
3.77 m

54.45 (41.51)  
7.17 m

73.97 (73.97)  
0.34 m

14.32 (14.32)  
3.87 m

16.40 (16.40)  
4.44 m

37.91 (37.91)  
3.59 m

12.08 (12.08)  
1.65 m

9.33 (9.33)  
1.18 m

80.42 (20.71)  
3.30 m

16.99 (16.99)  
1.01 m

41.02 (41.02)  
4.99 m

24.30 (24.30)  
4.67 m

122.35 (35.45)  
2.20 m

**Mineralized Drill Intersections Habanero Zone**

- > 10 g/t Au
- 5-10 g/t Au
- 3-5 g/t Au
- 1-3 g/t Au
- 0.1-1 g/t Au
- < 0.1 g/t Au

**Hole-ID**  
 g/t Au uncut (g/t Au cut\*)  
 True Width in metres  
 \*Assays cut to 140 g/t Au

- Pre-2018 Drilling
- 2018 Drilling (assays pending where not coloured)
- VG Visible Gold (where assays pending)

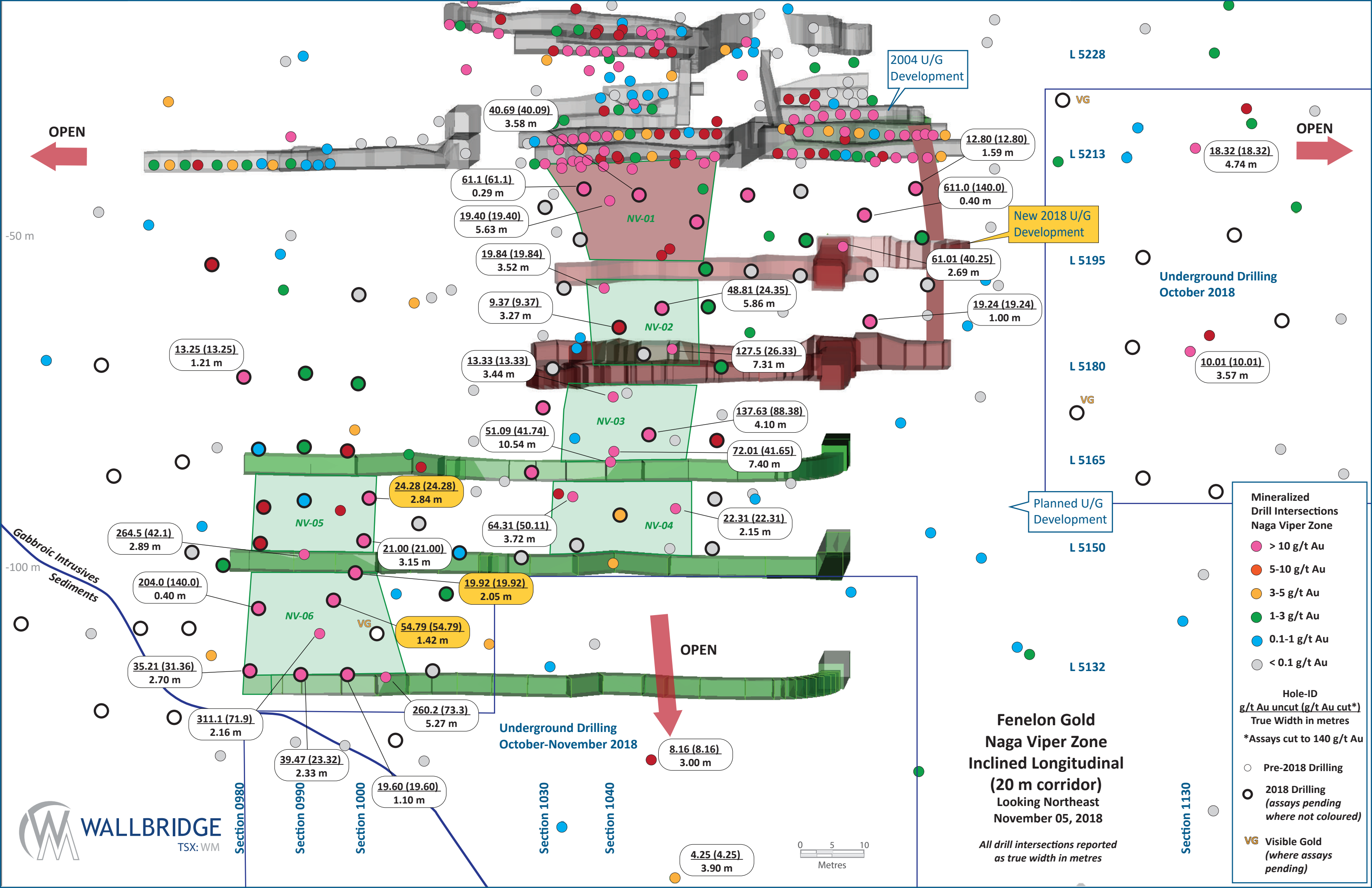

OPEN

OPEN

-50 m

Gabroic Intrusives  
Sediments

-100 m

OPEN

Underground Drilling  
October-November 2018

**Fenelon Gold  
Naga Viper Zone  
Inclined Longitudinal  
(20 m corridor)  
Looking Northeast  
November 05, 2018**

All drill intersections reported  
as true width in metres

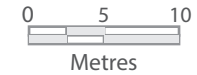

Section 0980

Section 0990

Section 1000

Section 1030

Section 1040

Section 1130

40.69 (40.09)  
3.58 m

61.1 (61.1)  
0.29 m

19.40 (19.40)  
5.63 m

19.84 (19.84)  
3.52 m

9.37 (9.37)  
3.27 m

13.33 (13.33)  
3.44 m

51.09 (41.74)  
10.54 m

24.28 (24.28)  
2.84 m

64.31 (50.11)  
3.72 m

21.00 (21.00)  
3.15 m

19.92 (19.92)  
2.05 m

54.79 (54.79)  
1.42 m

264.5 (42.1)  
2.89 m

204.0 (140.0)  
0.40 m

35.21 (31.36)  
2.70 m

311.1 (71.9)  
2.16 m

39.47 (23.32)  
2.33 m

19.60 (19.60)  
1.10 m

260.2 (73.3)  
5.27 m

4.25 (4.25)  
3.90 m

8.16 (8.16)  
3.00 m

72.01 (41.65)  
7.40 m

137.63 (88.38)  
4.10 m

127.5 (26.33)  
7.31 m

48.81 (24.35)  
5.86 m

12.80 (12.80)  
1.59 m

611.0 (140.0)  
0.40 m

61.01 (40.25)  
2.69 m

19.24 (19.24)  
1.00 m

18.32 (18.32)  
4.74 m

10.01 (10.01)  
3.57 m

L 5228

L 5213

L 5195

L 5180

L 5165

L 5150

L 5132

VG

VG

NV-01

NV-02

NV-03

NV-04

NV-05

NV-06

VG

2004 U/G  
Development

New 2018 U/G  
Development

Planned U/G  
Development

Underground Drilling  
October 2018

Underground Drilling  
October-November 2018

**Mineralized Drill Intersections Naga Viper Zone**

- > 10 g/t Au
- 5-10 g/t Au
- 3-5 g/t Au
- 1-3 g/t Au
- 0.1-1 g/t Au
- < 0.1 g/t Au

**Hole-ID**

- g/t Au uncut (g/t Au cut\*)
- True Width in metres
- \*Assays cut to 140 g/t Au

**Drilling Status**

- Pre-2018 Drilling
- 2018 Drilling (assays pending where not coloured)

**VG** Visible Gold (where assays pending)



# Fenelon Gold Chipotle Zone

## Inclined Longitudinal (10 m corridor)

Looking Northeast  
November 05, 2018

All drill intersections reported  
as true width in metres

- Mineralized  
Drill Intersections  
Chipotle Zone**
- > 10 g/t Au
  - 5-10 g/t Au
  - 3-5 g/t Au
  - 1-3 g/t Au
  - 0.1-1 g/t Au
  - < 0.1 g/t Au
- Hole-ID  
g/t Au uncut (g/t Au cut\*)  
True Width in metres**
- \*Assays cut to 140 g/t Au
- Pre-2018 Drilling
  - 2018 Drilling  
(assays pending  
where not coloured)
- Visible Gold  
VG  
(where assays  
pending)**

Open Pit

2004 U/G  
Development

New 2018 U/G  
Development

Planned U/G  
Development

**OPEN**



**OPEN**

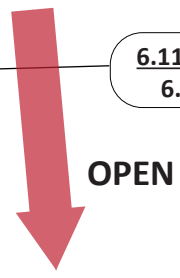

Underground Drilling  
October-November 2018

-50 m

-100 m

Section 0990

Section 1000

Section 1040

L 5228

L 5213

L 5195

L 5180

**13.97 (13.97)**  
0.61 m

**15.91 (15.91)**  
2.20 m

**16.72 (16.72)**  
1.08 m

**60.03 (19.88)**  
3.65 m

**9.27 (9.27)**  
2.76 m

**96.22 (36.57)**  
3.80 m

**27.10 (24.69)**  
5.56 m

**16.33 (16.33)**  
2.72 m

**10.09 (10.09)**  
1.33 m

**28.30 (28.30)**  
0.44 m

**144.96 (78.10)**  
1.77 m

**32.44 (22.58)**  
3.82 m

**65.76 (42.89)**  
1.78 m

**30.47 (30.47)**  
2.72 m

**12.57 (12.57)**  
9.94 m

**29.23 (28.35)**  
3.26 m

**116.2 (41.79)**  
7.74 m

**12.68 (12.68)**  
2.38 m

**50.31 (25.18)**  
5.51 m

**9.77 (9.77)**  
5.74 m

**6.11 (6.11)**  
6.64 m

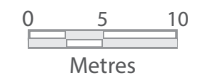



**Geology (U/G Mapping)**

- Gabbroic Intrusives
- Intermediate Intrusives
- Argillite/Graphitic Argillite
- Silicified Shear Zones
- Quartz veins

**Mineralized Drill Intersections (> 3 g/t Au)**

- Previously released
- Hole-ID
- g/t Au uncut (g/t Au cut\*)
- True Width in metres
- \*Assays cut to 140 g/t Au

**2018 Drill setup**  
All drill hole names correspond to setup (e.g. 18-0990-006 drilled from setup 0990)

